

**Check Valve,**  
Female thread



**Function:**

These valve are used to keep the flow of air completely blocked in one direction while in opposite direction air can flow freely.

**Technical Data:**

Type	CV-M5	CV-1/8	CV-1/4	CV-3/8	CV-1/2
Art. No.	981406	981415	981424	981432	981440
Connection	M5	1/8"	1/4"	3/8"	1/2"
Flow rate (NI/min)	80	900	1600	2400	3500
Fluid	Compressed air lubricated or non-lubricated				
Pressure range	2...10 bar				
Cracking pressure	2 bar				
Temperature range	-10...+70 °C				
Mounting	Line fitting				
Body	Brass, nickle-plated				

**Dimensions (mm):**

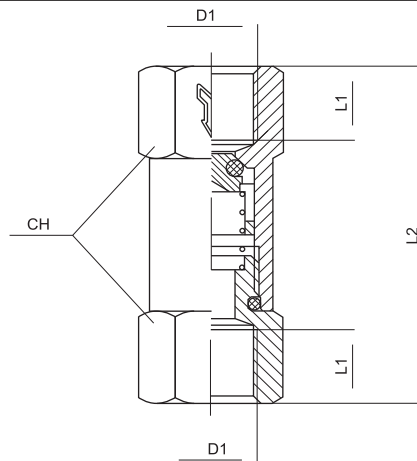

Type	D1	L1	L2	CH	Weight (g)
CV-M5	M5	5	25	8	8
CV-1/8	1/8"	8	36.5	13	25
CV-1/4	1/4"	9	41	16	41
CV-3/8	3/8"	10.5	51	20	73
CV-1/2	1/2"	12.5	62	24	120