

**Single Solenoid Valve,**  
Internal pilot operated, spring return

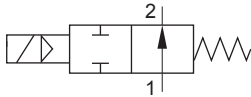

**Function:**

When the coil is energized, the valve shifts its normal position & remains shifted until the coil is de-energized.



**Technical Data:**

Type	MOV-2-3/8	MOV-2-1/2	MOV-2-3/4	MOV-2-1	MOV-2-1½	MOV-2-2
Art. no.	62607	62609	62613	62617	62621	62624
Connection	G3/8	G1/2	G3/4	G1	G1½	G2
Valve function	2/2 way					
Design	Servo assisted diaphragm valve					
Type of mounting	In-line mounting					
Norminal dia (mm)	12.7	12.7	19	25	37	50
Flow factor k.v (l/min)	35	40	90	176	350	600
Operating medium	Air, water, inert gasses, oil & any other media compatible with the materials of construction.					
Operating pressure range (bar)	0.15...10	0.15...10	0.15...10	0.15...8	0.15...10	0.15...10
Temperature range	-10...+90 °C					
Operating voltage	12, 24, 48, 110 V DC; 24, 48, 110, 230 V AC/50...60 Hz					
Power consumption	DC voltage 5.5 W; AC voltage 8 VA				VDC 8 W; VAC 13 VA	
Protection class	IP 65					
Materials	Body: Brass; Seals: NBR; Internal parts: Stainless steel					
Weight (g)	650	650	900	1300	1500	2000

**Note:** For magnetic coils see sheets 4.6.2 & 4.6.3.

**Dimensions (mm):**

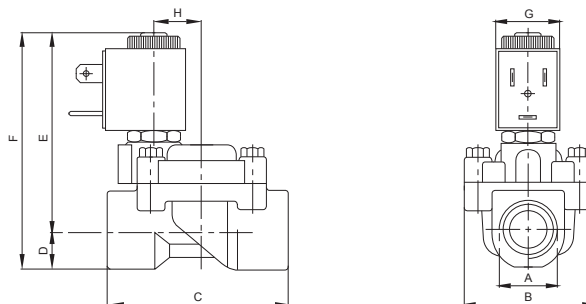

A	B	C	D	E	F	G	H
G3/8	45	64	14	73	87	22	17
G1/2	45	64	14	73	87	22	17
G3/4	54	82	17	84	101	22	22
G1	72.5	100	20	94	114	22	30.5
G1-1/2	97.5	134	28	114	142	30	41.5
G2	119	152	36	121	157	30	48