

**Double Pilot Valve,  
Spring centered**

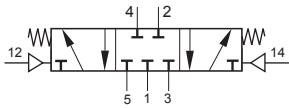

**Function:**

Pressure on the pilot port individually actuates the spool of the valve, until the pilot signal is removed.



**Technical Data:**

Type	PDPV-5/3-1/8	PDPV-5/3-1/4	PDPV-5/3-3/8	PDPV-5/3-1/2
Art. no.	63968	63987	639106	639125
Connection	G1/8	G1/4	G3/8	G1/2
Valve function	5/3-way			
Design	Piston spool			
Type of mounting	Via through-holes			
Norminal dia (mm)	5	8	10	12
Std. nominal flow rate (l/min)	650	1450	2250	3000
Operating medium	Filtered compressed air, lubricated or unlubricated			
Operating pressure range	2...10 bar	1.5...10 bar	1.5...10 bar	1...10 bar
Pilot pressure	3 bar			
Temperature range	-10...+60 °C			
Materials	Body: Wrought aluminium alloy, anodised; Seals: Nitrile rubber			
Weight (g)	200	440	490	690

**Dimensions (mm):**

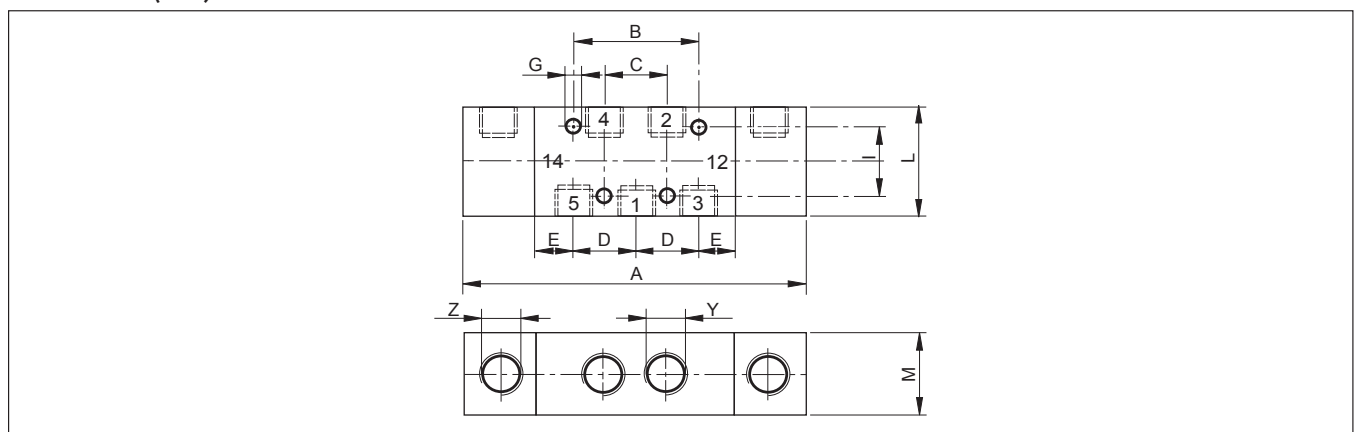

Connection (Y)	A	B	C	D	E	G	I	L	M	Z
G1/8	92	36	18	18	12	4.5	25	36	22	G1/8
G1/4	112	44	22	22	18	5.5	36	50	30	G1/8
G3/8	126	56	28	28	19	6.6	36	50	30	G1/8
G1/2	146	64	32	32	25	6.6	40	60	30	G1/8