

**Single Pilot Valve,**  
Air spring return

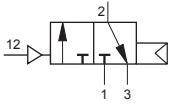

**Function:**

Pressure on the pilot port actuates the spool of the valve till the removal of pilot pressure.

If pressure is attached to port 1 the function is normally closed. If pressure is attached to port 3 the function is normally open. Do not attach pressure at port 2.



**Technical Data:**

Type	PPV-3-1/8	PPV-3-1/4	PPV-3-3/8	PPV-3-1/2
Art. no.	63957	63978	63997	639116
Connection	G1/8	G1/4	G3/8	G1/2
Valve function	3/2-way			
Design	Piston spool			
Type of mounting	Via through-holes			
Norminal dia (mm)	5	8	10	12
Std. nominal flow rate (l/min)	650	1450	2250	3000
Operating medium	Filtered compressed air, lubricated or unlubricated			
Operating pressure range	2...10 bar	1.5...10 bar	1.5...10 bar	1...10 bar
Pilot pressure	2 bar	1.5 bar	1.5 bar	1 bar
Temperature range	-10...+60 °C			
Materials	Body: Wrought aluminium alloy, anodised; Seals: Nitrile rubber			
Weight (g)	130	290	320	450

**Dimensions (mm):**

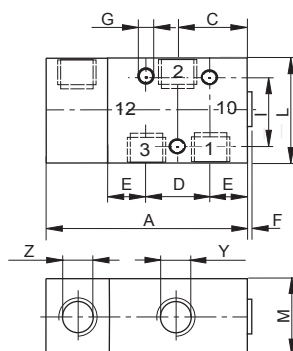

Connection (Y)	A	C	D	E	F	G	I	L	M	Z
G1/8	58	36	18	12	1	4.5	25	36	22	G1/8
G1/4	74	44	22	18	-	5.5	36	50	30	G1/8
G3/8	82	56	28	19	1	6.6	36	50	30	G1/8
G1/2	98	64	32	25	-	6.6	40	60	30	G1/8

Subject to change