

Single Acting Cylinder

Type CPCS-...

Adjustable cushioning at both ends
with magnet for proximity sensing



Type CPCS-...P

With pulling mode



Order example:

CPCS - 32 - 25 - P

CPCS - 32 - 25 - P
 Pulling mode
 Stroke length
 Diameter
 Type

Technical Data:

Operating medium	Filtered compressed air
Operating pressure	1.5 ... 10 bar
Temperature range	-20 ... + 80°C
Piston Ø	20, 25, 32, 40, 50, 63, 80 & 100 mm
Stroke length	1 ... 25 mm
Standard stroke	5, 10, 15, 20, 25 mm

Materials:

Cylinder barrel	Aluminium, smooth anodised
Piston rod	Ø 20-25 AISI 303 Ø 32-100 Chromium coated steel
Caps, bearing & end	Die-cast aluminium
Piston	Die-cast aluminium
Seals	Polyurethane, nitrile rubber

Theoretical forces at 6 bar:

Piston Ø (mm)	Advancing force (N)	Spring return force (N)									
		Stroke 5		Stroke 10		Stroke 15		Stroke 20		Stroke 25	
		Min.	Max.	Min.	Max.	Min.	Max.	Min.	Max.	Min.	Max.
20	160	8	9	7	9	6	9	5	9	4	9
25	243	19	22	16	22	13	22	10	22	7	22
32	407	24	27	21	27	18	27	14	27	11	27
40	642	33	36	29	36	26	36	23	36	19	36
50	1,006	50	54	45	54	41	54	37	54	32	54
63	1,606	69	76	62	76	55	76	48	76	41	76
80	2,617	87	96	81	96	73	96	66	96	58	96
100	4,144	87	95	79	95	71	95	63	95	55	95

Dimensions (mm):

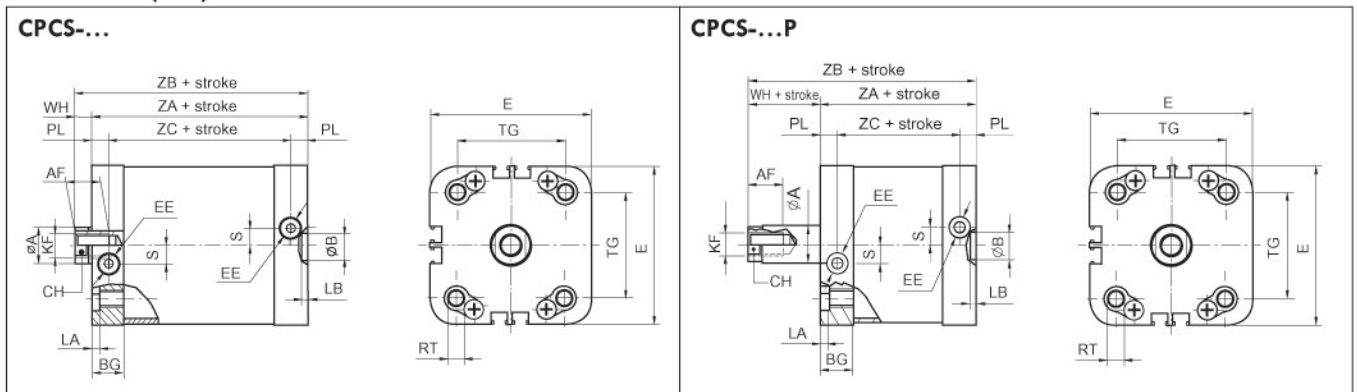

Ø mm	ØA	CH	AF	WH	ZA	ZB	ZC	KF	EE	BG	TG	E	RT	LA	PL	ØB	LB	S
20	10	9	10	6	37	43	23	M6X1	M5X0.8	14.25	22	36	M5X0.8	3	7	9	2.1	2.5
25	10	9	10	6	39	45	25	M6X1	M5X0.8	14	26	39.5	M5X0.8	3	7	9	2.1	2.5
32	12	10	12	7	44	51	28.5	M8X1.25	G1/8	15.5	32.5	49.5	M6X1	3.5	7.75	9	2.1	6
40	12	10	12	7	45	52	29.5	M8X1.25	G1/8	15.5	38	54	M6X1	3.5	7.75	9	2.1	8
50	16	13	16	8	45	53	29.5	M10X1.5	G1/8	14.5	46.5	69	M8X1.25	4	7.5	12	2.6	8
63	16	13	16	8	49	57	33.5	M10X1.5	G1/8	15.5	56.5	79	M8X1.25	4	7.75	12	2.6	11.5
80	20	17	20	10	54	64	36.5	M12X1.75	G1/8	17.5	72	94.5	M10X1.5	5	8.75	12	2.6	11.5
100	25	21	20	10	67	77	46	M12X1.75	G1/8	21	89	114.5	M10X1.5	5	10.5	12	2.6	20

Subject to change

3.3.1